

## TAIL BOARD, SINGLE SHEAVE, 2-12t



404



L-170



L-160



402

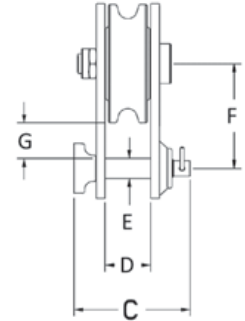
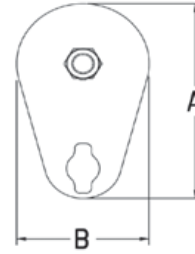

- Opening feature permits easy insertion of rope without reeving. Bolt for opening feature is retained, to ensure no lost bolts.
- Can be furnished with bronze bushings or roller bearings.
- Center pin equipped with pressure lube fitting.
- All sizes feature sheave grooves suited for a range of wire line diameters.
- Meets or exceeds all requirements of ASME B30.26 including identification ductility, design factor, proof load and temperature requirements. Importantly, these blocks meet other critical performance requirements including fatigue life and material traceability, not addressed by ASME B30.26.
- "All Alloy" snatch blocks feature a significant reduction in weight compared to snatch blocks made of non-alloy materials.
- Crosby's Engineered Solutions Group is ready to discuss your requirements and help select or develop the ideal block for your application. Call us at 1-800-777-1555.

Working Load Limit (t)*	Wire Rope Size (in)	Sheave Diameter (in)	Bearing Code	Weight Each (lb)	Catalog No.	Description	Stock No.	Dimensions (in)						
								A	B	C	D	E	F	G
2 tonnes														
2	5/16 - 3/8	3	BB	3	404	Light Champion	102016	4.87	3.00	2.64	1.04	0.50	2.62	0.87
4 tonnes														
4	3/8 - 1/2	4.5	BB	7	404	Light Champion	102025	7.75	4.25	3.13	1.56	0.75	4.25	1.63
5 tonnes														
5	3/8 - 1/2 ‡	4	BB	11	L-170	Lebus, General Purpose	599846	8.38	4.50	2.94	1.57	0.85	4.69	2.25
5	3/8 - 1/2 ‡	4	RB	11	L-170	Lebus, General Purpose	599855	8.38	4.50	2.94	1.57	0.85	4.69	2.25
6 tonnes														
6**	3/8 - 1/2	5	BB	13	L-160	Lebus, Heavy Duty	599542	8.25	5.12	3.69	1.53	0.75	4.25	1.38
6**	3/8 - 1/2	5	RB	13	L-160	Lebus, Heavy Duty	599551	8.25	5.12	3.69	1.53	0.75	4.25	1.38
8 tonnes														
8	5/8 - 3/4	6	BB	15	404	Light Champion	102098	9.87	6.00	4.19	1.80	1.00	5.12	1.62
8	5/8 - 3/4	6	RB	15	404	Light Champion	102114	9.87	6.00	4.19	1.80	1.00	5.12	1.62
8	5/8 - 3/4	8	BB	21	404	Light Champion	102169	11.93	8.12	4.19	1.80	1.00	6.12	1.62
8	5/8 - 3/4	8	RB	21	404	Light Champion	102187	11.93	8.12	4.19	1.80	1.00	6.12	1.62
8	5/8 - 3/4	10	BB	29	404	Light Champion	102230	14.00	10.12	4.19	1.80	1.00	7.19	1.69
8	5/8 - 3/4	10	RB	29	404	Light Champion	102258	14.00	10.12	4.19	1.80	1.00	7.19	1.69
8	5/8 - 3/4	12	BB	36	404	Light Champion	102301	16.81	12.12	4.19	1.80	1.00	9.00	2.50
8	5/8 - 3/4	12	RB	36	404	Light Champion	102329	16.81	12.12	4.19	1.80	1.00	9.00	2.50
12 tonnes														
12**	5/8 - 3/4	5.75	BB	29	L-160	Lebus, Heavy Duty	599604	9.97	6.00	4.19	1.72	1.00	5.22	1.85
12**	5/8 - 3/4	5.75	RB	29	L-160	Lebus, Heavy Duty	599613	9.97	6.00	4.19	1.72	1.00	5.22	1.85
12	3/4 - 7/8	6	BB	15	402	All Alloy	179238	9.87	6.00	4.19	1.80	1.00	5.12	1.62
12	3/4 - 7/8	6	RB	15	402	All Alloy	179283	9.87	6.00	4.19	1.80	1.00	5.12	1.62
12	3/4 - 7/8	8	BB	21	402	All Alloy	179318	11.93	8.12	4.19	1.80	1.00	6.12	1.62
12	3/4 - 7/8	8	RB	21	402	All Alloy	179363	11.93	8.12	4.19	1.80	1.00	6.12	1.62
12	3/4 - 7/8	10	BB	29	402	All Alloy	179434	14.00	10.12	4.19	1.80	1.00	7.19	1.69
12	3/4 - 7/8	10	RB	29	402	All Alloy	179498	14.00	10.12	4.19	1.80	1.00	7.19	1.69

\* Ultimate Load is 4 times the Working Load Limit. \*\* Ultimate Load is 3.5 times the Working Load Limit. ‡ Special Dual Groove Sheave also accepts 1-1/4" Manila Rope.

McKissick Blocks