

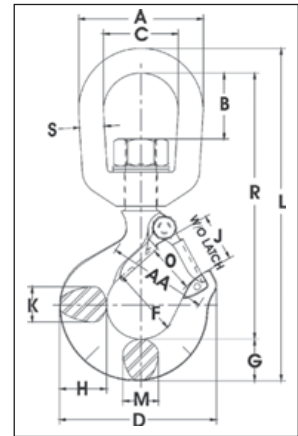

**L-322CN / L-322AN**  
(L-322AN Shown)

- Forged - Quenched and Tempered.
- Swivel hooks are load rated.
- Proper design, careful forging, and precision controlled quench and tempering gives maximum strength without excessive weight and bulk.
- Low profile hook tip designed to utilize Crosby S-4320 or PL-N latch kit. Simply purchase the latch assemblies listed and shown on pages 121 - 122. Even years after purchase of the original hook, latch assemblies can be added.
- Hoist hooks incorporate markings forged into the product which address two (2) **QUIC-CHECK®** features:
  - **Deformation Indicators** -- Two strategically placed marks, one just below the shank or eye and the other on the hook tip, which allows for a QUIC-CHECK® measurement to determine if the throat opening has changed, thus indicating abuse or overload.
  - **Angle Indicators** — Indicates the maximum included angle which is allowed between two (2) sling legs in the hook. These indicators also provide the opportunity to approximate other included angles between two sling legs.
- Type Approval certification in accordance with ABS 2016 Steel Vessel Rules and ABS Guide for Certification of Lifting Appliances 2016 available. Certificates available when requested at time of order and may include additional charges.



Load Rated

Fatigue Rated



**SEE APPLICATION AND WARNING INFORMATION**  
 On Pages 144 - 145  
 Para Español: [www.thecrosbygroup.com](http://www.thecrosbygroup.com)



Suitable for infrequent, non-continuous rotation under load. Use in corrosive environment requires shank and nut inspection in accordance with ASME B30.10-1.10.4(b)(5)(c).

**L-322CN & L-322AN Swivel Hooks**

| Working Load Limit (t)* |       | Hook ID Code* | L-322CN Stock No. | L-322AN Stock No. | Weight Each (kg) | Dimensions (mm) |      |      |      |      |      |      |      |      |     |      |      |     |      | Rep. Latch Stock No. |         |
|-------------------------|-------|---------------|-------------------|-------------------|------------------|-----------------|------|------|------|------|------|------|------|------|-----|------|------|-----|------|----------------------|---------|
| Carbon                  | Alloy |               |                   |                   |                  | A               | B    | C    | D    | F    | G    | H    | J    | K    | L   | M    | O †  | R   | S    |                      | AA**    |
| .75                     | 1.25  | D             | 1048603           | 1048807           | .34              | 51.0            | 20.8 | 31.8 | 72.5 | 31.8 | 18.5 | 20.6 | 23.6 | 16.0 | 144 | 16.0 | 23.6 | 116 | 9.65 | 38.1                 | 1096325 |
| 1                       | 1.60  | F             | 1048612           | 1048816           | .57              | 63.5            | 33.3 | 38.1 | 80.0 | 35.1 | 21.3 | 23.9 | 24.6 | 18.0 | 170 | 18.0 | 24.6 | 136 | 12.7 | 50.8                 | 1096374 |
| 1.6                     | 2.50  | G             | 1048621           | 1048825           | 1.02             | 76.0            | 38.1 | 44.5 | 91.0 | 38.1 | 25.4 | 29.5 | 26.9 | 22.4 | 197 | 22.4 | 26.9 | 155 | 16.0 | 50.8                 | 1096421 |
| 2                       | 3.20  | H             | 1048630           | 1048834           | 1.04             | 76.0            | 38.1 | 44.5 | 102  | 41.1 | 28.7 | 33.3 | 30.2 | 23.9 | 210 | 23.9 | 29.5 | 165 | 16.0 | 50.8                 | 1096468 |
| 3.2                     | 5.4   | I             | 1048639           | 1048840           | 2.25             | 89.0            | 41.7 | 50.8 | 123  | 51.0 | 36.6 | 41.4 | 38.1 | 33.3 | 246 | 28.7 | 35.8 | 191 | 19.1 | 63.5                 | 1096515 |
| 5                       | 8.0   | J             | 1048648           | 1048859           | 4.67             | 116             | 58.0 | 63.5 | 160  | 63.5 | 46.0 | 52.5 | 45.2 | 42.2 | 317 | 36.6 | 42.9 | 245 | 25.4 | 76.2                 | 1096562 |
| 7.5                     | 11.5  | K             | 1048657           | 1048868           | 8.80             | 127             | 62.0 | 70.0 | 192  | 76.0 | 57.0 | 67.0 | 51.0 | 47.8 | 375 | 41.4 | 56.5 | 289 | 28.7 | 101                  | 1096609 |
| 10                      | 16    | L             | 1048666           | 1048880           | 10.5             | 143             | 63.0 | 79.0 | 212  | 82.5 | 66.0 | 74.5 | 66.5 | 55.5 | 417 | 49.3 | 61.0 | 311 | 31.8 | 101                  | 1096657 |
| 15                      | 22    | N             | 1048675           | 1048889           | 21.3             | 180             | 95.5 | 104  | 263  | 108  | 76.0 | 89.0 | 86.5 | 68.5 | 542 | 60.5 | 81.0 | 424 | 38.1 | 127                  | 1096704 |
| -                       | 31.5  | O             | -                 | 1048898           | 32.0             | 180             | 95.5 | 104  | 346  | 127  | 93.0 | 118  | 102  | 72.5 | 590 | 76.2 | 82.6 | 459 | 38.1 | 165                  | 1090161 |

\* Carbon swivel hooks .75tC-15tC: proof load is 2 times working load limit. Designed with a 5 to 1 safety factor. Alloy swivel hooks 1tA - 30tA : proof load is 2.5 times working load limit. Designed with a 4 to 1 safety factor. Alloy swivel hook 30tA: proof load is 2 times working load limit. Designed with a 4 to 1 design factor. \*\* Deformation Indicators † Dimensions for hooks 3/4t carbon thru 22t alloy are for S-4320 latch kits. Dimensions for hooks 30t alloy are for 4055 latch kit.