

Heavy Lift Swivel Hoist Rings

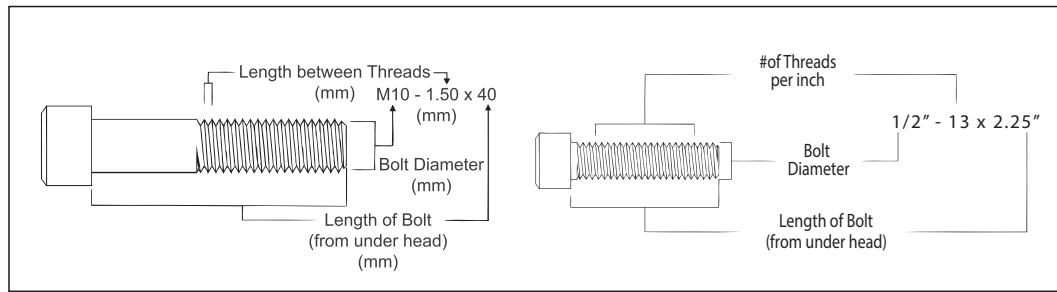

HR-1000CT

- All load bearing components are heat treated, Quenched & Tempered alloy steel.
- All components, with the exception of the retaining ring, are produced with maximum material hardness of 34 HRC. All primary load bearing components have Charpy impact testing. The body, bushing, washer and bail meet impact requirements of 31 ft-lbs min. avg. at -4°F. The bolt meets impact requirements of 20 ft-lbs min. avg. at -150°F.
- Individually Mag inspected with certification
- Forged bail provides the following:
 - Easily readable raised lettering showing the name Crosby or "CG" and PIC Code for material traceability.
 - Greater durability providing the increased "Toughness" desired in potentially abusive field conditions
 - Larger opening than standard Hoist Ring bail.
- Top washer is color coded for easy identification (blue for UN threads and grey for Metric threads)
- The Working Load Limit and Recommended Torque value are permanently stamped into each washer.
- Individually Proof Tested to 2 times Working Load Limit (90° and in-line).
- **BOLT SIZE IDENTIFICATION:** The size of the bolt will be stated as in the drawing above. Illustration shows meaning of each dimension given.
- **NOTE:** For Special Applications, see page 457.
- Type approval and certification in accordance with DNV offshore Standard DNV-OS-E101, Drilling Plant, October 2013 and Standard for Certification No. 2.22 Lifting Appliances.
- Frame 2 and larger are **RFID EQUIPPED**.
- Individually serialized.
- 100% MPI all primary load bearing components.
- Coating: Thermo-diffusion galvanized.
- Optional bolt sizes available upon request.

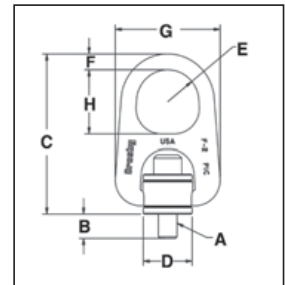

Fatigue Rated



Load Rated

SEE APPLICATION AND WARNING INFORMATION
On Pages 210 - 211
Para Español: www.thecrosbygroup.com

HR-1000CT UN Threads

Frame Size No.	HR-1000CT Stock No.	Working Load Limit (lb)*	Torque (ft•lbf)	Dimensions (in)								Mass Each (lb)
				Bolt Size A ‡	Eff. Thread Projection Length B	C	D	Radius E	Diameter F	G	H	
2	6608103	1900	28	1/2 - 13 x 2.25	0.70	6.32	1.96	1.25	0.75	4.20	2.50	3
2	6608112	1900	28	1/2 - 13 x 2.75	1.20	6.32	1.96	1.25	0.75	4.20	2.50	3
2	6608121	3000	60	5/8 - 11 x 2.25	0.70	6.32	1.96	1.25	0.75	4.20	2.50	3
3	6608130	4800	100	3/4 - 10 x 3.00	0.85	8.59	2.96	1.63	1.00	6.25	3.25	11
3	6608139	6200	160	7/8 - 9 x 3.00	0.85	8.59	2.96	1.63	1.00	6.25	3.25	11
3	6608148	8300	230	1 - 8 x 3.50	1.35	8.59	2.96	1.63	1.00	6.25	3.25	11
4	6608149	12500	470	1-1/4 - 7 x 5.00	2.10	11.31	3.71	2.00	1.44	8.13	4.00	24
4	6607669	20000	800	1-1/2 - 6 x 5.50	2.60	11.31	3.71	2.00	1.44	8.13	4.00	27
4	6607727	20000	800	1-1/2 - 8 x 5.50	2.60	11.31	3.71	2.00	1.44	8.13	4.00	27
5	6607670	28000	1100	2 - 4.5 x 7.50	3.20	15.15	4.00	2.69	1.75	11.64	5.00	69
6	6607671	45000	2100	2 1/2 - 4 x 9.50	3.73	19.93	5.75	3.00	2.75	14.47	5.62	157

*Ultimate Load is 5 times the Working Load Limit. ‡ Bolt specification is an Alloy socket head cap screw to ASTM A320 Grade L7 or L43.
NOTE: The tightening torque values shown are based upon threads being clean, dry and free of lubrication.