



G-2170
Grommet
Shackle



Scan our QR Code with your smart device to visit the online flye .

- All sizes Quenched and Tempered for maximum strength.
- All sizes cast alloy steel.
- All ratings are in metric tons, embossed on side of bow.
- G-2170 bows are furnished Dimetcoated and pins are Dimetcoated, then painted red.
- All sizes are **RFID EQUIPPED** in bow and pin.
- Designed for use with single or double large diameter grommets.
- Extra large sling contact area improves efficiency of the grommet sling
- Shackles utilize new Easy-Loc bolt system
- Large machined flat on ears that can be drilled and tapped for adapting other accessories.
- Increases usable sling strength minimum of 60% and greatly improves life of grommet slings.
- Bow and bolt are certified to meet charpy impact testing of 42 Joules (31 ft•lbf) min. avg. at -20° C (-4° F).
- All 2170 shackles are individually proof tested and magnetic particle inspected.
- Shackles requiring ABS, Lloyds, and other certifications are available upon special request and must be specified at time of order .
- All 2170 shackles can meet requirements of DNV Rules for Certification of Lifting Appliances upon special request and must be specified t time of order.
 - Serialization / Identificatio
 - Material Testing (Physical / Chemical / Charpy)
 - Proof Testing
- Look for the Red Pin®...the mark of genuine Crosby quality.

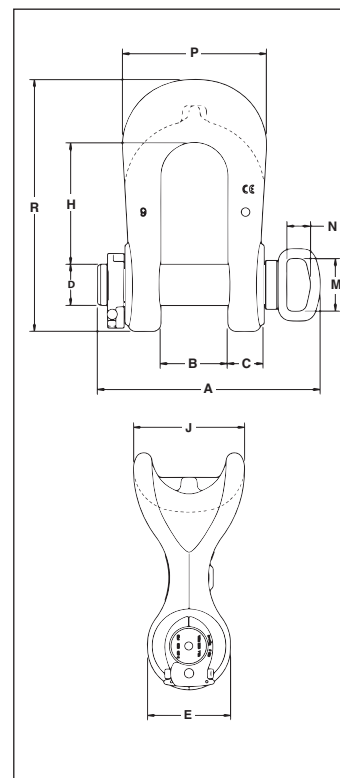

SEE APPLICATION INFORMATION

On Page 92 of the General Catalog
Para Español: www.thecrosbygroup.com

G-2170 Crosby® Grommet Shackles

| Working Load Limit (t)* | Stock No. | Weight Each (lb) | Dimensions (in) | | | | | | | | | | | Effective Body Diameter |
|-------------------------|-----------|------------------|-----------------|-----------|------|-----------|-------|-------|-------|------|------|-------|-------|-------------------------|
| | | | A | B +/- .25 | C | D +/- .02 | E | H | J | M | N | P | R | |
| 75 | 1023147 | 115 | 15.04 | 4.13 | 2.39 | 2.75 | 5.50 | 7.77 | 7.50 | 4.00 | 1.80 | 9.38 | 16.20 | 11.25 |
| 125 | 1023156 | 179 | 17.01 | 5.13 | 2.75 | 3.15 | 6.72 | 9.31 | 9.00 | 4.00 | 1.80 | 11.00 | 19.25 | 13.50 |
| 200 | 1023174 | 374 | 19.35 | 5.91 | 3.39 | 4.12 | 9.00 | 11.64 | 12.90 | 4.00 | 1.80 | 13.63 | 25.01 | 18.45 |
| 300 | 1023183 | 692 | 22.61 | 7.38 | 4.30 | 5.25 | 11.13 | 15.20 | 15.50 | 4.00 | 1.80 | 17.00 | 31.82 | 22.75 |
| 500 | 1022119 | 1671 | 29.95 | 9.84 | 6.00 | 7.09 | 13.75 | 19.72 | 20.00 | 4.00 | 1.80 | 23.00 | 41.44 | 30.00 |

* Note: Maximum Proof Load is 2 times the Working Load Limit on 75 thru 300 metric tons. Minimum Ultimate Load is 5 times the Working Load Limit on 75 thru 300 metric tons. Maximum Proof Load is 1.33 times the Working Load Limit on 500 metric tons. Minimum Ultimate Load is 4.5 times the Working Load Limit on 500 metric tons.